

DO NOT SCALE
DIMENSIONS IN mm

METRIC

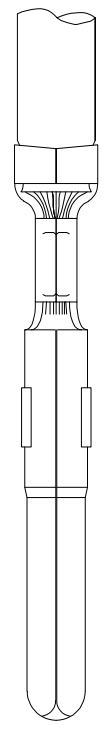
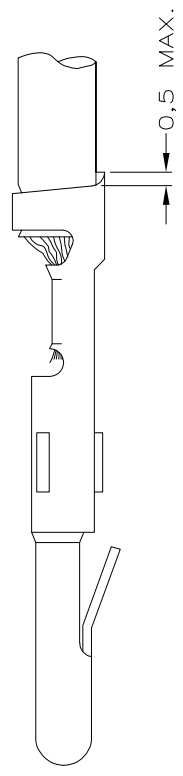
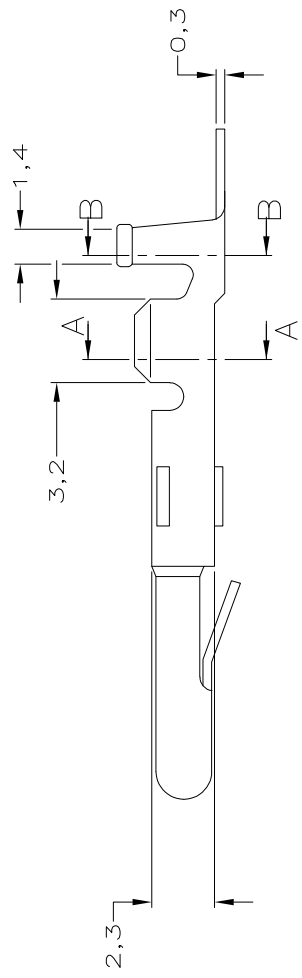
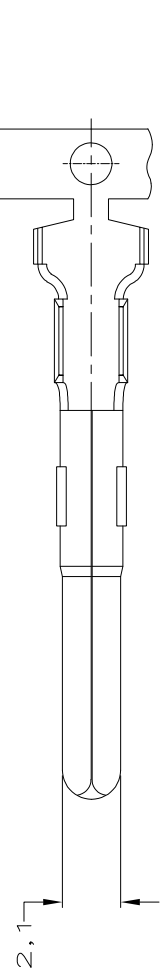
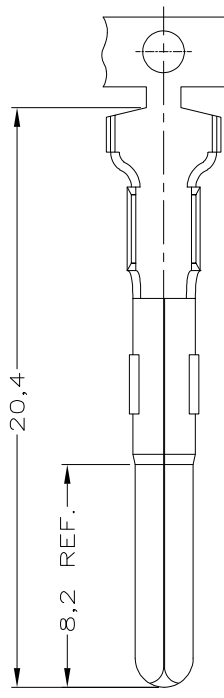
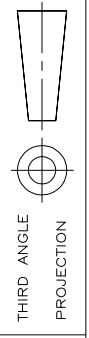

NOTES:

- 1 FOR USE ON STANDARD APPLICATORS.(RIGHT-LEFT FEED)
- 2 FOR USE ON MINIATURE APPLICATORS.(LEFT-RIGHT FEED)
- 3 FOR USE ON MINIATURE APPLICATORS, AMP O-MATOR APPLICATION.(LEFT-RIGHT FEED)
- 4 OBSOLETE PARTS: OBSOLETE CIS STREAMLINING PER D.RENAUD/D.SINISI

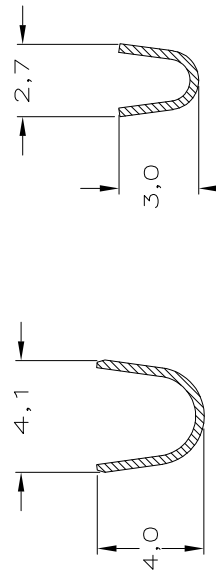

WIRE RANGE :	8-163301-3
0,5-1,0mm ² AWG	1-163301-7
INSULATION RANGE :	1-163301-2
1,8-3,3mm DIA.	1-163301-1

SECTION B-B SECTION A-A

OBsolete		SEL. GOLD	
4	2	NICKEL	BRASS
	3	NICKEL	BRASS
	1	NICKEL	BRASS
	2	PRE-TINPLATED	PHOSPHOR BR.
4	2	UNPLATED	PHOSPHOR BR.
	2	PRE-TINPLATED	BRASS
	2	UNPLATED	BRASS
	1	PRE-TINPLATED	PHOSPHOR BR.
	1	UNPLATED	PHOSPHOR BR.
	1	PRE-TINPLATED	BRASS
	1	UNPLATED	BRASS
PLATING		MATERIAL	
PLATING		PARTNUMBER	

SUP BY 163301-6

CUSTOMER DRAWING FOR REFERENCE ONLY
 WILL NOT BE UPDATED
 © COPYRIGHT 19 - BY -
 ALL INTERNATIONAL RIGHTS RESERVED.
 THIS DRAWING IS UNPUBLISHED
 RELEASED FOR PUBLICATION - 19 -

NAME
STE TE Connectivity
 PIN MATE-N-LOK.

K2 REVISED PER ECO-11-05294 RK HMR 05APR11
 DR.: J.V.D.HEIJDEN, CHK.: A.BIJNEN, APP.: L.V.SOEST.
 DATE: 10-04-92 DATE: - DATE: -