

© THIS DRAWING IS THE EXCLUSIVE PROPERTY OF ROBERT BOSCH GMBH. WITHOUT THEIR CONSENT IT MAY NOT BE REPRODUCED OR GIVEN TO THIRD PARTIES.

**KOMPAKT 4 4 WAY
WITH CPA**
SECONDARY LOCKING OPEN
CPA OPEN

**Kompakt 4 4polig
mit CPA**
Sekundärverriegelung offen
CPA offen

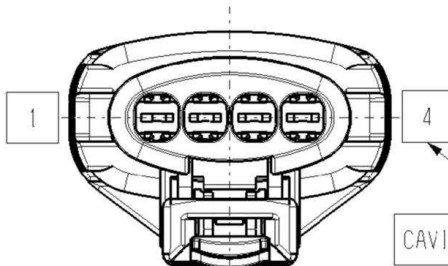
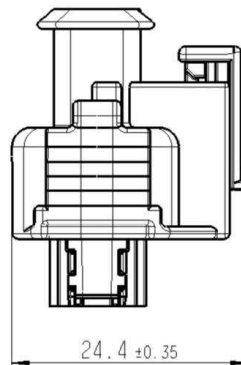
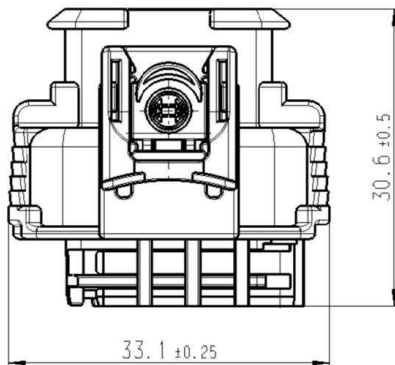
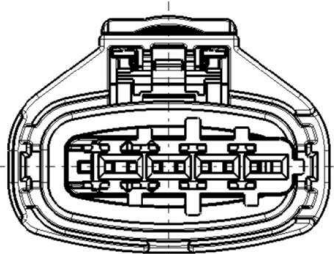

CAVITY-NO. /Kammer-Nr.

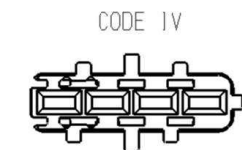
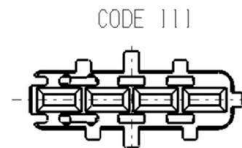
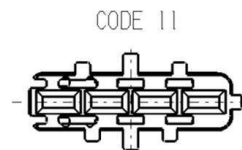
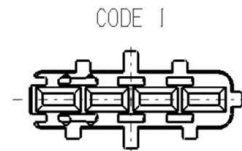

***) ATTENTION: SAMPLE PARTS NO. ONLY VALID FOR B-SAMPLE**
***) Achtung: Musterteile-Nr. nur für B-Muster gültig**

WITH STANDARD SEAL (VMQ) Mit Standard-Dichtung (VMQ)	CODE I	CODE II	CODE III	CODE IV
COLOR OF SECONDARY LOCKING Farbe der Sekundärverriegelung	BLUE blau	GREY grau	GREEN grün	NATURE natur
SAMPLE NO. / Muster-Nr. *)	1 928 D01 688-02	1 928 D02 639-01		
ORDER NO. / Bestell-Nr.	1 928 405 525	1 928 405 788		
SAMPLE NO. / Muster-Nr. *)	1 928 D01 928-01●	1 928 D02 640		
ORDER NO. / Bestell-Nr.	1 928 405 587 ●	1 928 405 789-01		

● = FOR OXYGEN SENSOR APPLICATION / für Lambdasondenanwendung

Weitere Informationen zur Steckverbindung: siehe Seite 11 - 17
FURTHER INFORMATION TO THE PLUG CONNECTION: SEE PAGE 11 - 17

© Alle Rechte bei ROBERT BOSCH GMBH, auch für den Fall von Schutzrechtsanmeldungen. Jede Verfügungsbefugnis, wie Kopier- und Weitergaberecht, bei uns

					OFFER DRAWING		Angebotszeichnung	
13	REVISED	Fm	13.07.2016	Ka	BOSCH	NO. / Nr.	en/de	SHEET /
NO.	MODIFICATION	SIGN	VALID	CHE.		1 928 A00 517		Blatt 8
Nr.	Änderung	gez	gültig	gepr.				SH./ 17