

Cu lisovací oka lehčená

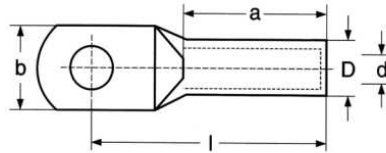

Použitý materiál: měď
 Povrchová úprava: galvanické cínování
 Další varianty: s nahlížecím otvorem typ / S
 pro flexibilní vodiče typ / F

Průřez (mm ²)	Označení	Svorník (mm)	Rozměry (mm)					Hmotnost (kg/100ks)	Balení (ks)
			b	D	d	l	a		
0,25 - 0,75	OL 0,75-M3	3,2	6,0	2,6	1,3	12,0	6,0	0,071	100
	OL 0,75-M4	4,3	6,5	2,6	1,3	13,0	6,0	0,074	100
	OL 0,75-M5	5,3	7,5	2,6	1,3	14,0	6,0	0,082	100
0,75 - 1,5	OL 1,5-M3	3,2	6,5	3,3	1,8	12,0	6,0	0,118	100
	OL 1,5-M4	4,3	6,5	3,3	1,8	13,0	6,0	0,134	100
	OL 1,5-M5	5,3	7,5	3,3	1,8	14,0	6,0	0,145	100
	OL 1,5-M6	6,5	9,0	3,3	1,8	16,0	6,0	0,169	100
1,5 - 2,5	OL 2,5-M3	3,2	7,5	4,2	2,3	12,0	6,0	0,146	100
	OL 2,5-M4	4,3	7,5	4,2	2,3	13,0	6,0	0,157	100
	OL 2,5-M5	5,3	8,5	4,2	2,3	14,0	6,0	0,172	100
	OL 2,5-M6	6,5	9,5	4,2	2,3	16,0	6,0	0,192	100
	OL 2,5-M8	8,5	13,0	4,2	2,3	20,0	6,0	0,220	100
4 - 6	OL 4-M4	4,3	8,5	5,0	3,0	17,0	8,0	0,201	100
	OL 4-M5	5,3	9,0	5,0	3,0	17,0	8,0	0,214	100
	OL 4-M6	6,5	10,0	5,0	3,0	19,0	8,0	0,237	100
	OL 4-M8	8,5	13,0	5,0	3,0	22,0	8,0	0,274	100
6	OL 6-M4	4,3	9,5	6,5	4,0	17,0	9,0	0,520	100
	OL 6-M5	5,5	9,5	6,5	4,0	19,0	9,0	0,500	100
	OL 6-M6	6,5	10,0	6,5	4,0	19,0	9,0	0,470	100
	OL 6-M8	8,4	14,0	6,5	4,0	22,0	9,0	0,540	100
	OL 6-M10	10,5	17,0	6,5	4,0	22,0	9,0	0,590	100
	OL 6-M12	13,0	18,0	6,5	4,0	22,0	9,0	0,630	100
10	OL 10-M4	4,3	12,0	7,0	4,6	19,0	10,0	0,530	100
	OL 10-M5	5,5	12,0	7,0	4,6	22,0	10,0	0,500	100
	OL 10-M6	6,5	12,0	7,0	4,6	22,0	10,0	0,490	100
	OL 10-M8	8,4	15,0	7,0	4,6	25,0	10,0	0,580	100
	OL 10-M10	10,5	17,0	7,0	4,6	27,0	10,0	0,620	100
	OL 10-M12	13,0	19,0	7,0	4,6	28,5	10,0	0,640	100
16	OL 16-M5	5,5	12,0	8,5	5,5	26,0	13,0	0,840	100
	OL 16-M6	6,5	12,0	8,5	5,5	27,0	13,0	0,860	100
	OL 16-M8	8,4	15,0	8,5	5,5	29,0	13,0	0,930	100
	OL 16-M10	10,5	17,0	8,5	5,5	31,0	13,0	0,990	100
	OL 16-M12	13,0	19,0	8,5	5,5	33,0	13,0	1,020	100
	OL 16-M16	17,0	21,5	8,5	5,5	39,5	13,0	1,170	100
25	OL 25-M5	5,5	14,0	10,0	7,0	30,0	15,0	1,220	25
	OL 25-M6	6,5	14,0	10,0	7,0	30,0	15,0	1,200	100
	OL 25-M8	8,4	16,0	10,0	7,0	32,0	15,0	1,310	100
	OL 25-M10	10,5	18,0	10,0	7,0	34,0	15,0	1,570	100
	OL 25-M12	13,0	19,0	10,0	7,0	35,0	15,0	1,390	25
	OL 25-M16	17,0	21,5	10,0	7,0	39,0	15,0	1,430	25
35	OL 35-M6	6,5	17,0	12,0	8,5	32,0	17,0	1,850	100
	OL 35-M8	8,4	17,0	12,0	8,5	34,5	17,0	2,000	100
	OL 35-M10	10,5	19,0	12,0	8,5	37,0	17,0	2,130	100
	OL 35-M12	13,0	21,0	12,0	8,5	38,0	17,0	2,120	100
	OL 35-M14	15,0	21,0	12,0	8,5	40,0	17,0	2,180	25
	OL 35-M16	17,0	26,0	12,0	8,5	42,0	17,0	2,240	25
	OL 35-M20	21,0	30,0	12,0	8,5	46,0	17,0	2,200	25

Cu lisovací oka lehčená

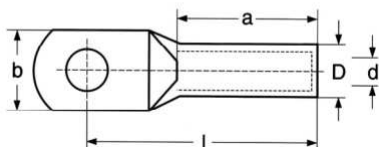

Použitý materiál: měď
 Povrchová úprava: galvanické cínování
 Další varianty: s nahlížecím otvorem typ / S
 pro flexibilní vodiče typ / F

Průřez (mm ²)	Označení	Svorník (mm)	Rozměry (mm)					Hmotnost (kg/100ks)	Balení (ks)
			b	D	d	l	a		
50	OL 50-M6	6,5	20,0	14,0	10,0	37,0	19,0	3,000	25
	OL 50-M8	8,4	20,0	14,0	10,0	37,0	19,0	2,930	50
	OL 50-M10	10,5	20,0	14,0	10,0	39,0	19,0	3,080	50
	OL 50-M12	13,0	23,0	14,0	10,0	43,0	19,0	3,230	50
	OL 50-M16	17,0	28,0	14,0	10,0	46,0	19,0	3,380	25
	OL 50-M20	21,0	30,0	14,0	10,0	48,0	19,0	3,460	25
70	OL 70-M6	6,5	23,0	16,5	12,0	43,0	21,0	4,490	25
	OL 70-M8	8,4	23,0	16,5	12,0	43,0	21,0	4,380	50
	OL 70-M10	10,5	23,0	16,5	12,0	44,0	21,0	4,540	50
	OL 70-M12	13,0	23,0	16,5	12,0	46,0	21,0	4,630	50
	OL 70-M16	17,0	28,0	16,5	12,0	50,0	21,0	4,240	25
	OL 70-M20	21,0	30,0	16,5	12,0	53,0	21,0	5,090	25
95	OL 95-M6	6,5	26,0	18,0	13,5	48,0	25,0	5,480	25
	OL 95-M8	8,4	26,0	18,0	13,5	48,0	25,0	5,440	25
	OL 95-M10	10,5	26,0	18,0	13,5	48,0	25,0	5,400	50
	OL 95-M12	13,0	26,0	18,0	13,5	49,0	25,0	5,560	50
	OL 95-M16	17,0	28,0	18,0	13,5	52,0	25,0	5,820	50
	OL 95-M20	21,0	36,0	18,0	13,5	58,0	25,0	6,710	25
120	OL 120-M6	6,5	28,0	18,5	15,0	51,0	26,0	6,900	25
	OL 120-M8	8,4	28,0	18,5	15,0	51,0	26,0	6,720	25
	OL 120-M10	10,5	28,0	18,5	15,0	51,0	26,0	6,570	50
	OL 120-M12	13,0	28,0	18,5	15,0	51,0	26,0	6,380	50
	OL 120-M16	17,0	30,0	18,5	15,0	53,0	26,0	6,450	50
	OL 120-M20	21,0	36,0	18,5	15,0	59,0	26,0	7,740	25
150	OL 150-M8	8,5	31,0	21,0	16,5	58,0	28,0	7,780	10
	OL 150-M10	10,5	31,0	21,0	16,5	58,0	28,0	7,620	10
	OL 150-M12	13,0	31,0	21,0	16,5	58,0	28,0	7,730	25
	OL 150-M16	17,0	31,0	21,0	16,5	58,0	28,0	7,530	10
	OL 150-M20	21,0	36,0	21,0	16,5	64,0	28,0	8,800	10
185	OL 185-M8	8,5	35,0	24,0	19,0	65,0	30,0	11,800	10
	OL 185-M10	10,5	35,0	24,0	19,0	65,0	30,0	11,750	10
	OL 185-M12	13,0	35,0	24,0	19,0	65,0	30,0	11,820	10
	OL 185-M16	17,0	35,0	24,0	19,0	65,0	30,0	11,240	25
	OL 185-M20	21,0	39,0	24,0	19,0	69,0	30,0	12,000	10
240	OL 240-M10	10,5	39,0	26,0	21,0	72,0	35,0	14,720	10
	OL 240-M12	13,0	39,0	26,0	21,0	72,0	35,0	14,550	10
	OL 240-M16	17,0	39,0	26,0	21,0	72,0	35,0	14,090	25
	OL 240-M20	21,0	39,0	26,0	21,0	72,0	35,0	13,600	10
300	OL 300-M12	13,0	48,0	30,0	23,5	87,0	44,0	23,330	5
	OL 300-M16	17,0	48,0	30,0	23,5	87,0	44,0	22,740	5
	OL 300-M20	21,0	48,0	30,0	23,5	87,0	44,0	22,190	5