

Part number

CKSM 04



male insert, CKS series, spring terminal connection, 4 poles + PE, 10 A 400 V 4 kV 3, size "21.21"

Product description		Material properties	
Product type	Insert	Main material	polycarbonate
Series	CKS	Colour	RAL 7032 grey
Connection type	spring terminal connection		Compliant with exemption 6(c): copper alloy containing up to 4% lead by weight
Gender	male	RoHs conformity	
N. of poles	4 poles + 	China RoHs - EFUP	50
Size	size "21.21"	REACH SVHC substances	Yes Lead
Technical data		Approvals / Standards	
Current	10 A	Reference standard	EN 61984:2009-06
Voltage	400 V	General ordering information	
Rated impulse withstand voltage	4 kV	EAN13 code	8015747164382
Pollution degree	3	ETIM 7.0	EC000438
Rated voltage according to UL/CSA	600 V	Packaging Information	
Wire cross-section	0,14 mm ² - 2,50 mm ²	Packaging length	210,00 mm
AWG size	26 - 14	Packaging height	200,00 mm
Contact type	turned silver plated	Packaging width	130,00 mm
IP degree of protection	IP20 without enclosure, IP44/IP66/IP67/IP68/IP69 with enclosure	Packaging weight	2,90 kg
		Packaging volume	5,46 dm ³
Further technical details		Packaging description	Carton box
Characteristics according to EN 61984	10A 400V 4kV 3; 10A 690V 4kV 2	Packaging quantity	200 Pcs
Mating cycles	≥ 500	Packaging EAN code	8015747164436
Insulation resistance	≥ 10 GΩ	Sub-packaging weight	0,58 kg
Weight	14,80 g	Sub-packaging description	Carton tray
Operating temperature range (min, max)	-40 °C ... +125 °C	Sub-packaging quantity	40 Pcs
Conductors stripping length	9...11 mm	Sub-packaging EAN barcode	8015747164443
UL 94 flammability rating	V-0		
Torque for main contact	M2,5: 0.4 Nm; 3.5 lb.in (0,5 x 3mm)		
Tightening torque for PE connection	M4: 1,2 Nm, 10,6 lb.in (Ph2 or 1,0x5,5mm)		
Tightening torque for fixing screws	M3: 0,5 Nm; 4,4 lb.in (Ph1 or 0,8 x 5,5 mm)		

Part number
CKSM 04



Catalogue drawings

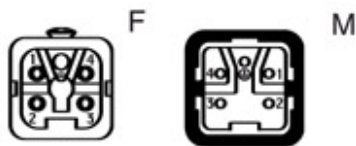
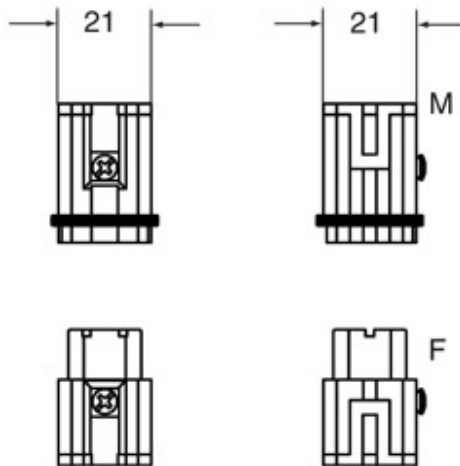

Catalogue drawings

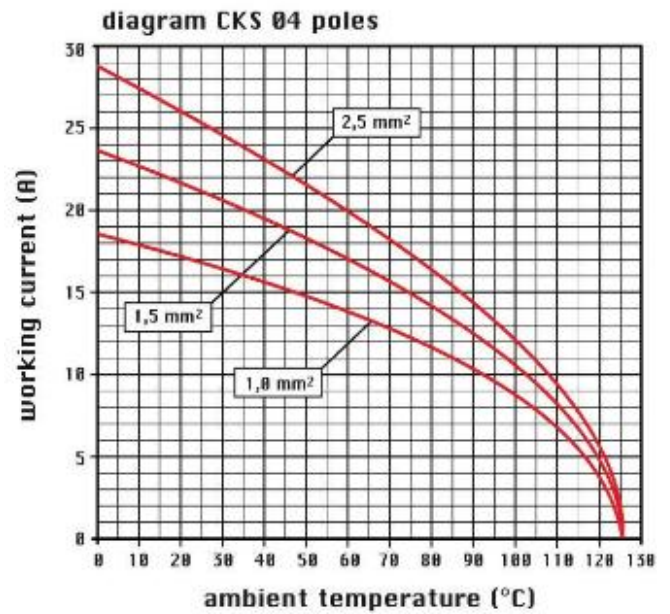

Notes

Dimensions shown in mm are not binding and may be changed without notice.

Spring terminal connections

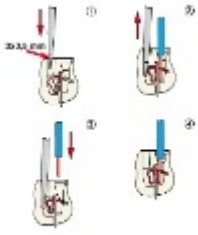

Rear top entry of wires for a more easier wiring.
